

www.landandbuildings.co.in

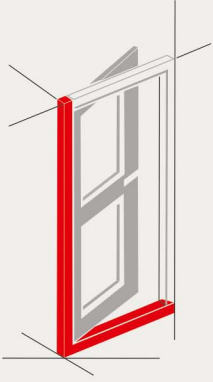

LAND & BUILDINGS

Engineers & Constructors



LIVING TERRACE 7

SAI KRUPA

Lakshmanasamy Salai

K.K.NAGAR

3BHK | 1526 SQ.FT

RERA not applicable



Do more living in your Terrace !

Yes, besides offering a lifestyle living experience, Sai Krupa goes a step further in making living more memorable not for just a day... but everyday ! The roofed terrace lets you to enjoy the sun & the rain. Thoughtfully designed homes & the terrace lets you live every moment indoors & outdoors. Sai Krupa promises a luxurious living that perfectly align with your desires.

- Site : Plot No.337, New No.93, Lakshmanasamy Salai, K.K.Nagar, Chennai-600 078.
- Land Area : 5300 S.ft
- Total Units : 8 Nos
- Apartments : 1B / 2B / 3B / 4B

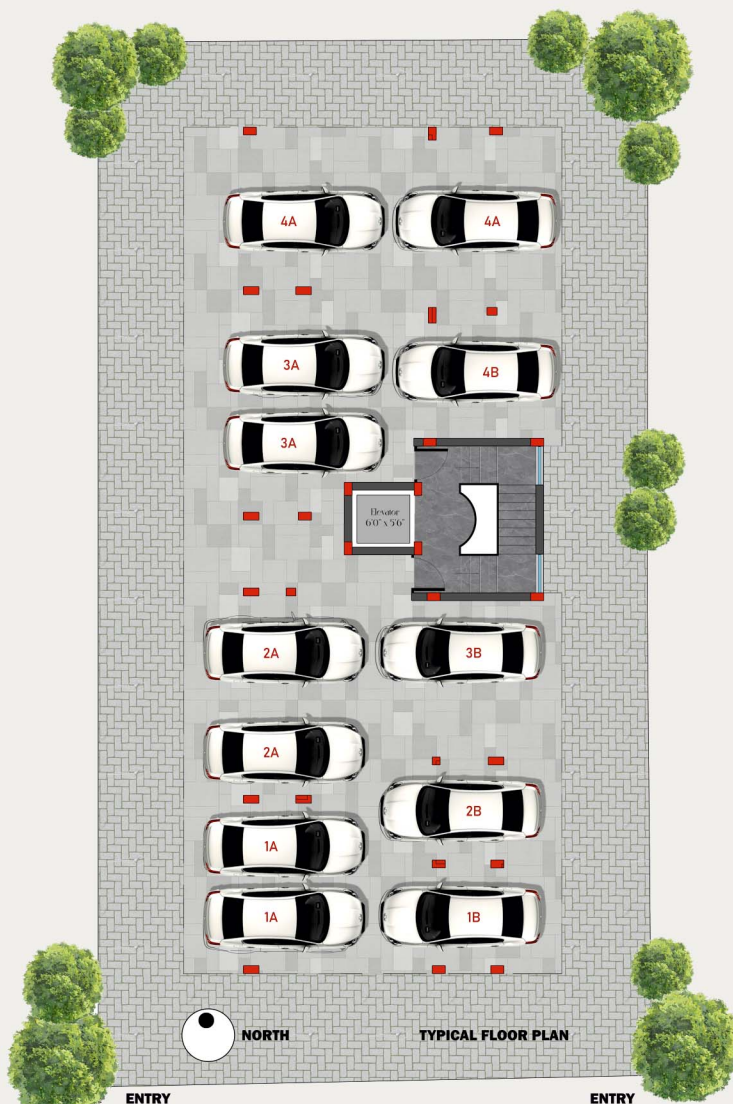

CAR PARK PLAN



TYPICAL FLOOR PLAN | 1526 SQ.FT
UDS FOR EACH APARTMENT | 606 sq.ft

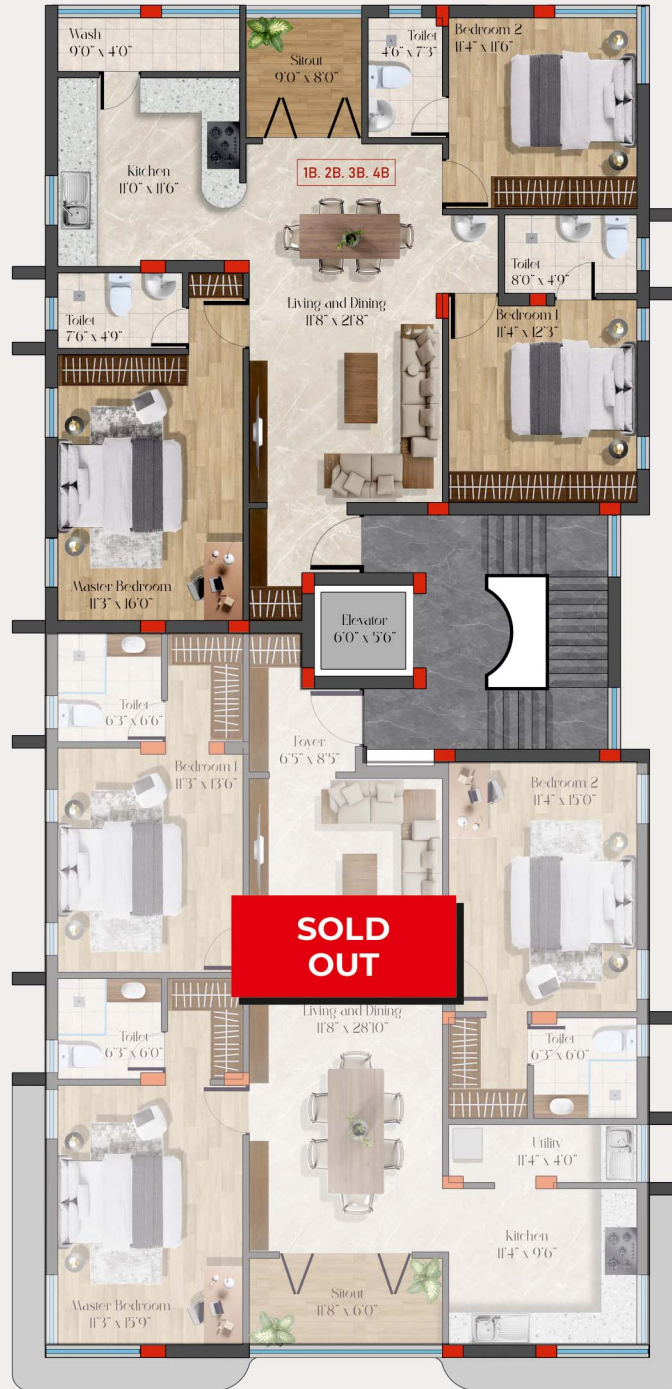

**SOLD
OUT**



SPECIFICATION KEY HIGHLIGHTS

STRUCTURE	:	■ RCC framed structure shall be designed to Earthquake resistance by a registered structural engineer.
DOORS	:	■ 8' 0" ht frames for main door, bedroom doors and restroom. ■ Wheel Chair access bathroom door 2'9" with grab bar.
TILING	:	■ Living & Dining 6' 0" x 4' 0" of Sunheart. ■ Bedroom wooden type of tiles. ■ Bathroom up to ceiling height.
ELECTRICAL	:	■ Necessary light, fan and power points. ■ All bedrooms and living. ■ All AC power points provided.
PLUMBING	:	■ Each flat separate pipe lines with meter provision.
SANITARY	:	■ Jaguar / Roca

AMENITIES & ESSENTIALS @ SAI KRUPA



CCTV
Surveillance

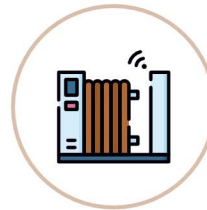

Automated
Sliding Gates



Timer Control of
Common Lights



Lift upto
Terrace

ARCHITECTS



Vaanara Sena
DESIGN LABORATORY

STRUCTURAL



ELECTRICAL



LAND & BUILDINGS: #17/13, 16th Avenue, Ashok Nagar,
Chennai 600 083 | landandbuildings@gmail.com

 **90800 98800 / 97906 44180**

www.landandbuildings.co.in

Scan for Video & Details

